

42/159

81 11864

PLAT OF MILLWOOD

A PARCEL OF LAND LYING IN THE N.E. 1/4 OF THE N.E. 1/4 OF SECTION 7, TOWNSHIP 44 SOUTH, RANGE 43 EAST. PALM BEACH COUNTY, FLORIDA

SHEET 1 OF 2
AUGUST, 1980

159

STATE OF FLORIDA
COUNTY OF PALM BEACH
THIS PLAT WAS FILED FOR RECORD AT 2:31 PM THIS 29 DAY OF June AD, 1981 AND DULY RECORDED IN PLAT BOOK 48 ON PAGES 189 AND 190.
JOHN B. DUNKLE, CLERK
CIRCUIT COURT,
BY: *[Signature]* DC.

DEDICATION

KNOW ALL MEN BY THESE PRESENTS THAT MR. HAROLD J. WILLIAMS AND MRS. TAWANA M. WILLIAMS, HIS WIFE, OWNERS OF THE LAND SHOWN HEREON, BEING IN SECTION 7, TOWNSHIP 44 SOUTH, RANGE 43 EAST, PALM BEACH COUNTY, FLORIDA, SHOWN HEREON AS PLAT OF MILLWOOD BEING MORE PARTICULARLY DESCRIBED AS FOLLOWS:

THE WEST 250.00 FEET OF THE SOUTH 420.00 FEET OF THE NORTH 640.00 FEET OF THE EAST ONE-HALF OF THE NORTHEAST ONE-QUARTER OF THE NORTHEAST ONE-QUARTER OF SAID SECTION SEVEN.

HAVE CAUSED THE SAME TO BE SURVEYED AND PLATTED AS SHOWN HEREON AND DO HEREBY DEDICATE AS FOLLOWS:

- TRACT "C" AS SHOWN IS HEREBY DEDICATED TO THE MILLWOOD PROPERTY OWNERS ASSOCIATION, IN PERPETUITY, FOR THE CONSTRUCTION AND MAINTENANCE OF UTILITIES, DRAINAGE AND AS AN EASEMENT OF INGRESS AND EGRESS TO AND FROM "TRACT A".
- TRACT "B" AND "D" AS SHOWN ARE HEREBY DEDICATED TO THE MILLWOOD PROPERTY OWNERS ASSOCIATION, IN PERPETUITY FOR THE CONSTRUCTION AND MAINTENANCE OF PARKING, UTILITIES, DRAINAGE AND AS A RECREATION AREA.
- THE LIMITED ACCESS EASEMENTS AS SHOWN ARE DEDICATED TO THE BOARD OF COUNTY COMMISSIONERS OF PALM BEACH COUNTY, FLORIDA, FOR THE PURPOSES OF CONTROL AND JURISDICTION OVER ACCESS RIGHTS.
- UTILITY EASEMENTS AS SHOWN HEREON, ARE HEREBY DEDICATED IN PERPETUITY FOR THE CONSTRUCTION AND MAINTENANCE OF UTILITIES.

IN WITNESS WHEREOF, WE MR. HAROLD J. WILLIAMS AND MRS. TAWANA M. WILLIAMS HERETO SET OUR HANDS. THIS 29 DAY OF June, 1981.

[Signature]
MR. HAROLD J. WILLIAMS
WITNESS TO BOTH SIGNATURES

[Signature]
MRS. TAWANA M. WILLIAMS
WITNESS TO BOTH SIGNATURES

ACKNOWLEDGEMENT

STATE OF FLORIDA }
COUNTY OF PALM BEACH } SS

BEFORE ME PERSONALLY APPEARED MR. HAROLD J. WILLIAMS AND MRS. TAWANA M. WILLIAMS HIS WIFE TO ME WELL KNOWN AND KNOWN TO ME TO BE THE PERSONS DESCRIBED IN AND WHO EXECUTED THE FOREGOING INSTRUMENTS AND ACKNOWLEDGED BEFORE ME THAT THEY EXECUTED SAID INSTRUMENTS FOR THE PURPOSES EXPRESSED THEREIN.

WITNESS MY HAND AND OFFICIAL SEAL THIS 29 DAY OF January, 1981.

NOTARY PUBLIC: *[Signature]*
MY COMMISSION EXPIRES: June 10, 1984

TITLE CERTIFICATION

STATE OF FLORIDA }
COUNTY OF PALM BEACH } SS

WE, COMMUNITY TITLE CORP., A TITLE INSURANCE COMPANY, DULY LICENSED IN THE STATE OF FLORIDA DO HEREBY CERTIFY THAT WE HAVE EXAMINED THE TITLE TO THE HEREON DESCRIBED PROPERTY, THAT WE FIND THAT THE TITLE TO THE PROPERTY IS VESTED TO MR. HAROLD J. WILLIAMS AND MRS. TAWANA M. WILLIAMS, THAT THE CURRENT TAXES HAVE BEEN PAID, AND THAT THE PROPERTY IS ENCUMBERED BY THE MORTGAGE SHOWN HEREON, AND THAT WE FIND THAT ALL MORTGAGES ARE SHOWN AND ARE TRUE AND CORRECT.

DATE: 5/29/81
[Signature]
COMM. TITLE CORP.

MORTGAGEE'S CONSENT

STATE OF FLORIDA }
COUNTY OF PALM BEACH } SS

THE UNDERSIGNED HEREBY CERTIFIES THAT IT IS THE HOLDER OF A MORTGAGE UPON THE PROPERTY DESCRIBED HEREON AND DOES HEREBY JOIN IN AND CONSENT TO THE DEDICATION OF THE LAND DESCRIBED IN SAID DEDICATION BY THE OWNER THEREOF AND AGREES THAT ITS MORTGAGE WHICH IS RECORDED IN OFFICIAL RECORD BOOK 2517 AT PAGE 1267 OF THE PUBLIC RECORDS OF PALM BEACH COUNTY, FLORIDA, SHALL BE SUBORDINATED TO THE DEDICATION SHOWN HEREON.

IN WITNESS WHEREOF, THE SAID CORPORATION HAS CAUSED THESE PRESENTS TO BE SIGNED BY ITS VICE PRESIDENT AND ATTESTED TO BY ITS SECRETARY AND ITS CORPORATE SEAL TO BE AFFIXED HEREON BY AND WITH THE AUTHORITY OF ITS BOARD OF DIRECTORS THIS 29 DAY OF DECEMBER, 1980.

ATTEST: *[Signature]* BY: *[Signature]*
FIRST FEDERAL SAVINGS AND LOAN ASSOCIATION OF LAKE WORTH

ACKNOWLEDGEMENT

STATE OF FLORIDA }
COUNTY OF PALM BEACH } SS

BEFORE ME PERSONALLY APPEARED CHARLES L. ROSSETTI AND JANET T. BELLETTI, TO ME WELL KNOWN, AND KNOWN TO ME TO BE THE INDIVIDUALS DESCRIBED IN AND WHO EXECUTED THE FOREGOING INSTRUMENT AS VICE PRESIDENT AND ASST. SECRETARY OF THE FIRST FEDERAL SAVINGS AND LOAN ASSOCIATION OF LAKE WORTH, A CORPORATION, AND SEVERALLY ACKNOWLEDGED TO AND BEFORE ME THAT THEY EXECUTED SUCH INSTRUMENT AS SUCH OFFICERS OF SAID CORPORATION, AND THAT THE SEAL AFFIXED TO THE FOREGOING INSTRUMENT IS THE CORPORATE SEAL OF SAID CORPORATION AND THAT IT WAS AFFIXED TO SAID INSTRUMENT BY DUE AND REGULAR CORPORATE AUTHORITY, AND THAT SAID INSTRUMENT IS THE FREE ACT AND DEED OF SAID CORPORATION.

WITNESS MY HAND AND OFFICIAL SEAL THIS 29 DAY OF DECEMBER, 1980.

MY COMMISSION EXPIRES: October 12, 1982
[Signature]
NOTARY PUBLIC

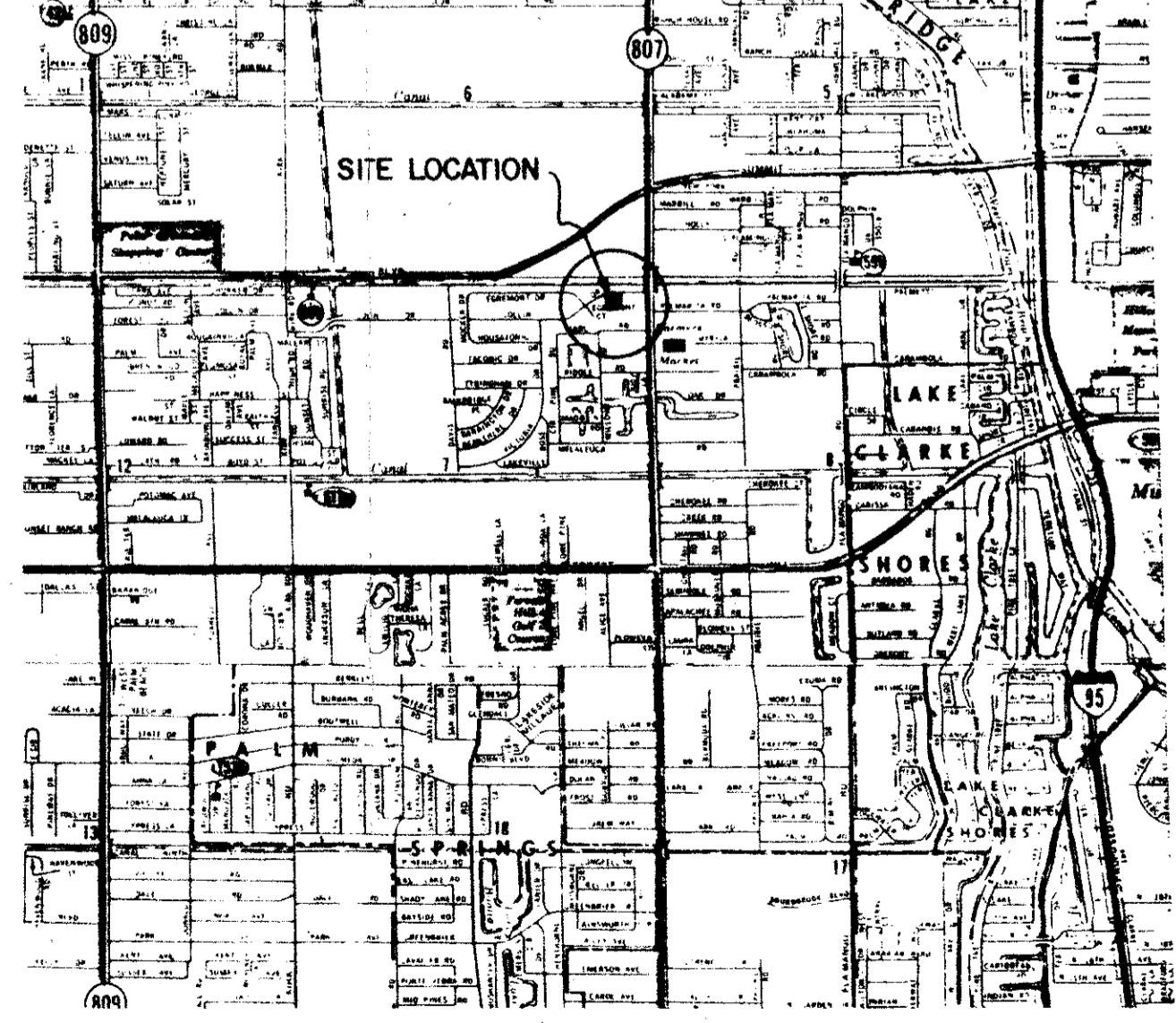

LOCATION MAP

APPROVALS

BOARD OF COUNTY COMMISSIONERS
PALM BEACH COUNTY, FLORIDA

THIS PLAT IS HEREBY APPROVED FOR RECORD THIS 29 DAY OF June, 1981.

BY: *[Signature]*
FRANK M. FOSTER, JR., CHAIRMAN

COUNTY ENGINEER

THIS PLAT IS HEREBY APPROVED FOR RECORD THIS 29 DAY OF June, 1981.

BY: *[Signature]*
HERBERT KAHLERT, COUNTY ENGINEER

ATTEST: JOHN B. DUNKLE, CLERK
BOARD OF COUNTY COMMISSIONERS

BY: *[Signature]*
DEPUTY CLERK

SURVIVOR'S CERTIFICATE

STATE OF FLORIDA }
COUNTY OF PALM BEACH } SS

THIS IS TO CERTIFY THAT THE PLAT SHOWN HEREON IS A TRUE AND CORRECT REPRESENTATION OF A SURVEY MADE UNDER MY RESPONSIBLE DIRECTION AND SUPERVISION AND THAT SAID SURVEY IS ACCURATE TO THE BEST OF MY KNOWLEDGE AND BELIEF AND THAT (P.R.M.'S) PERMANENT REFERENCE MONUMENTS HAVE BEEN PLACED AS REQUIRED BY LAW, AND THAT (P.C.P.'S) PERMANENT CONTROL POINTS WILL BE SET WITHIN ONE YEAR OF COMPLETION OF IMPROVEMENTS, AND FURTHER THAT THE SURVEY DATA COMPLIES WITH ALL THE REQUIREMENTS OF CHAPTER 177, FLORIDA STATUTES, AS AMENDED, AND ORDINANCES OF PALM BEACH COUNTY, FLORIDA.

DATE: 12TH DAY OF January, A.D., 1981.

BY: *[Signature]*

REGISTERED SURVEYOR NO. 2182
STATE OF FLORIDA

THIS INSTRUMENT WAS PREPARED BY MICHAEL B. LA TOUR IN THE OFFICES OF MERIDIAN SURVEYING AND MAPPING, INC., 2328 SO. CONGRESS AVE., WEST PALM BEACH, FLORIDA, 33406.

1000-024

Millwood

42/159

Zone RM
Sheet 4
FSZ 19-200 pidd.



Meridian
Surveying and mapping, inc.
2328 So. Congress Ave.
Suite 2-D
West Palm Beach, Florida 33406

PLAT OF MILLWOOD AUG. 1980
78-025